



PRODUCT NAME:
'GLOBAL STAINLESS' Series
 S/S SINGLE HOB TAP w/- S/S SWIVEL SPOUT



PART NUMBER:
 GS02S3006 + others (see chart below)

DESCRIPTION:
 S/S SINGLE HOB TAP BODY w/- S/S SWIVEL SPOUT w/- 360 DEGREE SWIVEL SPRING CHECK STEMS JUMPER VALVES.

TECHNICAL INFORMATION:
 - IDEAL WORKING PRESSURE 65 - 100 PSI
 - MAXIMUM PRESSURE = 200 PSI STATIC (in short periods)
 - MIN. EFFECTIVE PRESSURE - 50 PSI
 - WORKING TEMPERATURE 5 C - 65 C

SUPPLIED WITH:
 - S/S SINGLE HOB TAP BODY
 - S/S SWIVEL SPOUT
 - S/S 360 DEGREE SWIVEL CHECK STEMS JUMPER VALVES
 - S/S ALL THREAD + MOUNTING NUT AND WASHER

FEATURES:

TAP BODY:
 - S/S SINGLE HOB TAP BODY
 - S/S INTERNAL WORKINGS
 - S/S 360 DEGREE SWIVEL CHECK STEMS JUMPER VALVES
 - S/S SWIVEL SPOUT
 - CP LEVER HANDLES
 - 1/2" IN INLET

WELS:
 - 3 STAR, 9lpm

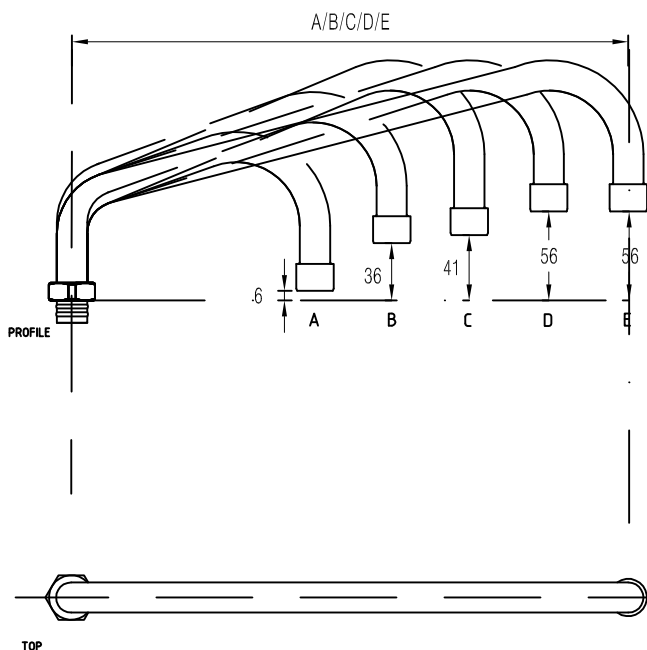
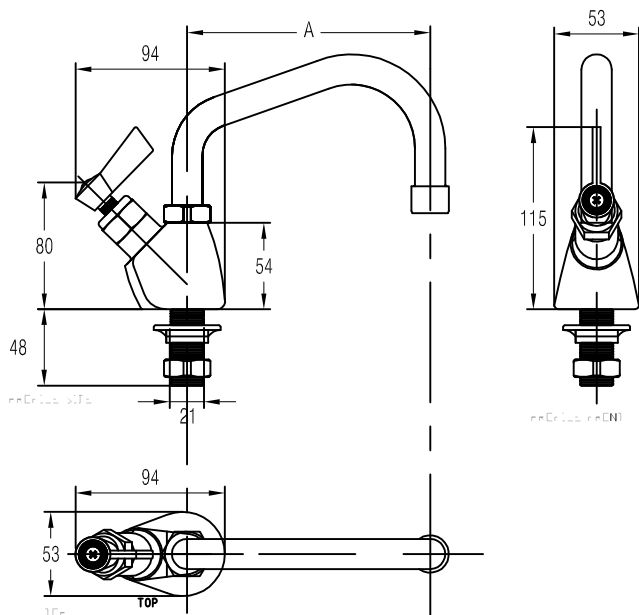

REF	MODEL	LENGTH (mm)	TAP With S/S SPOUT
A	6" MODEL	179mm	GS02S3006
B	8" MODEL	227mm	GS02S3008
C	10" MODEL	276mm	GS02S3010
D	12" MODEL	326mm	GS02S3012
E	14" MODEL	376mm	GS02S3014

WATERMARK & WELS:

Global Tapware Pty Ltd is a Watermarked, level 1, Company.
 All relevant products & components are WELS registered.

Special Notice:

- 1 - We reserve the right to make changes to products and drawings without notice.
- 2 - All drawings & Documents are subject to copyright ©.
- 3 - Seek written consent by us to reprint / use for other than specification work.

'GLOBAL STAINLESS' Series PT.NO. GS02S3006
 S/S SINGLE HOB TAP w/- S/S SWIVEL SPOUT