



PRODUCT NAME:
GLOBAL STAINLESS SERIES
S/S WALL SPOUT OUTLET ONLY - MALE INLET



PART NUMBER:
GS16S

DESCRIPTION:
S/S WALL SPOUT 1/2" MALE INLET

TECHNICAL INFORMATION:
- IDEAL WORKING PRESSURE:- 65 - 100 PSI
- REC. MIN. OPERATING PRESSURE :- 45 PSI
- MAXIMUM PRESSURE = 200 PSI STATIC (in short periods)
- WORKING TEMPERATURE 5 C - 65 C

FEATURES:
- S/S 1/2" MALE THREAD INLET SCREWS ONTO BACK SPLASH.
- ADJUSTABLE C.P. FLANGE
- TAKES SWIVEL SPOUTS, MOUNT DIRECTLY ONTO OUTLET

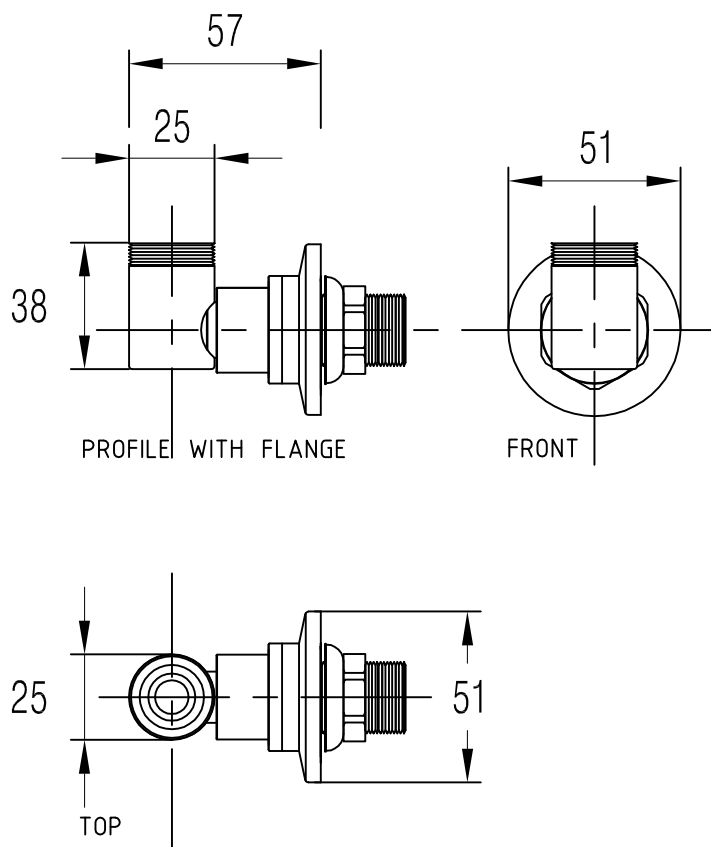

WATERMARK & WELS:

Global Tapware Pty Ltd is a Watermarked, level 1, Company.
All relevant products & components are WELS registered.

Special Notice:

- 1 - We reserve the right to make changes to products and drawings without notice.
- 2 - All drawings & Documents are subject to copyright ©.
- 3 - Seek written consent by us to reprint / use for other than specification work

GLOBAL STAINLESS SERIES PT.NO. GS16S
S/S WALL SWIVEL SPOUT OUTLET ONLY