



**PRODUCT NAME:**  
**'GLOBAL EC' & 'Q' SERIES**  
 WALL MOUNT ELBOW with & without  
 STANDARD SWIVEL SPOUT

**PART NUMBER:**  
 GEC16 / GEC16S / GEC16S3006 +

**DESCRIPTION:**  
 WALL MOUNT ELBOW BODY with & without  
 STANDARD SWIVEL SPOUT

**TECHNICAL INFORMATION:**  
 - IDEAL WORKING PRESSURE 65 - 100 PSI  
 - MAXIMUM PRESSURE = 200 PSI STATIC  
 (in short periods)  
 - WORKING TEMPERATURE 5 C - 65 C  
 - SHIPPING WEIGHT \_\_\_\_ KGS (approx)  
 - SCREWED MECHANICAL JOINTS

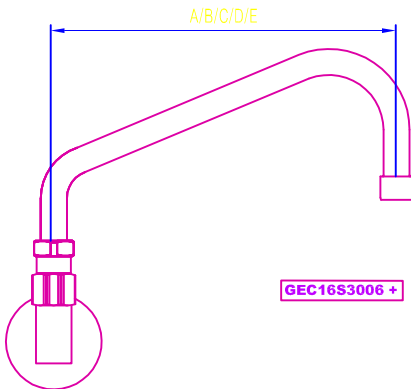

GEC16S

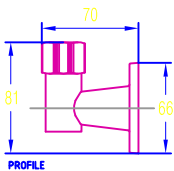

GEC16

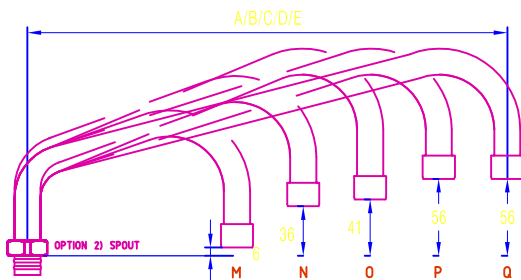

REF	LENGTH IN MM	PT.NO.	TAP WITH SPOUT	SPOUT HEIGHT
A	6" /179mm	G3006	GEC16S3006	6MM
B	8" /227mm	G3008	GEC16S3008	36MM
C	10" /276mm	G3010	GEC16S3010	41MM
D	12" /326mm	G3012	GEC16S3012	56MM
E	14" /376mm	G3014	GEC16S3014	56MM

**SUPPLIED WITH:**

- GEC16S3006 + :-
- C.P. WALL ELBOW WITH SWIVEL ADAPTOR
- C.P. SWIVEL STANDARD SPOUT - size as per chart.
- C.P. SWIVEL GOOSE NECK SPOUTS AVAILABLE TOO - 6" & 12"

- GEC16:-
- C.P. WALL ELBOW WITH 3/8" fi OUTLET

**FEATURES:**

- TAP BODY:**
- C.P. BRASS

**WATERMARK & WELS:**

Global Tapware Pty Ltd is a Watermarked, level 1, Company.  
 All relevant products & components are WELS registered.

**Special Notice:**

- 1 - We reserve the right to make changes to products and drawings without notice.
- 2 - All drawings & documents are subject to copyright (c).
- 3 - Seek written consent by us to reprint / use other than in specification work.

**GLOBAL EC' & 'Q' SERIES PT NO.GEC16S3006 +**  
 WALL MOUNT ELBOW with & without STANDARD SWIVEL SPOUT