

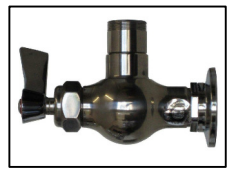

PRODUCT NAME:
GLOBAL STAINLESS SERIES
S/S SINGLE WALL TAP WITH SWIVEL OUTLET

PART NUMBER:
GS11S

DESCRIPTION:
S/S SINGLE TAP BODY WITH SWIVEL OUTLET
WITH 360 DEGREE SWIVEL CHECK STEMS
JUMPER VALVES.



TECHNICAL INFORMATION:
- IDEAL WORKING PRESSURE:- 65 - 100 PSI
- REC. MIN. OPERATING PRESSURE :- 45 PSI
- MAXIMUM PRESSURE = 200 PSI STATIC (in short periods)
- WORKING TEMPERATURE 5 C - 65 C

SUPPLIED WITH:
- S/S TAP BODY
- S/S SWIVEL SPOUT
- S/S 360 DEGREE SWIVEL CHECK STEMS JUMPER VALVES
- CP WALL COVER FLANGE

FEATURES:
TAP BODY:
- S/S BODY
- S/S INTERNAL WORKINGS
- CP LEVER HANDLES
- 1/2" FEMALE INLET

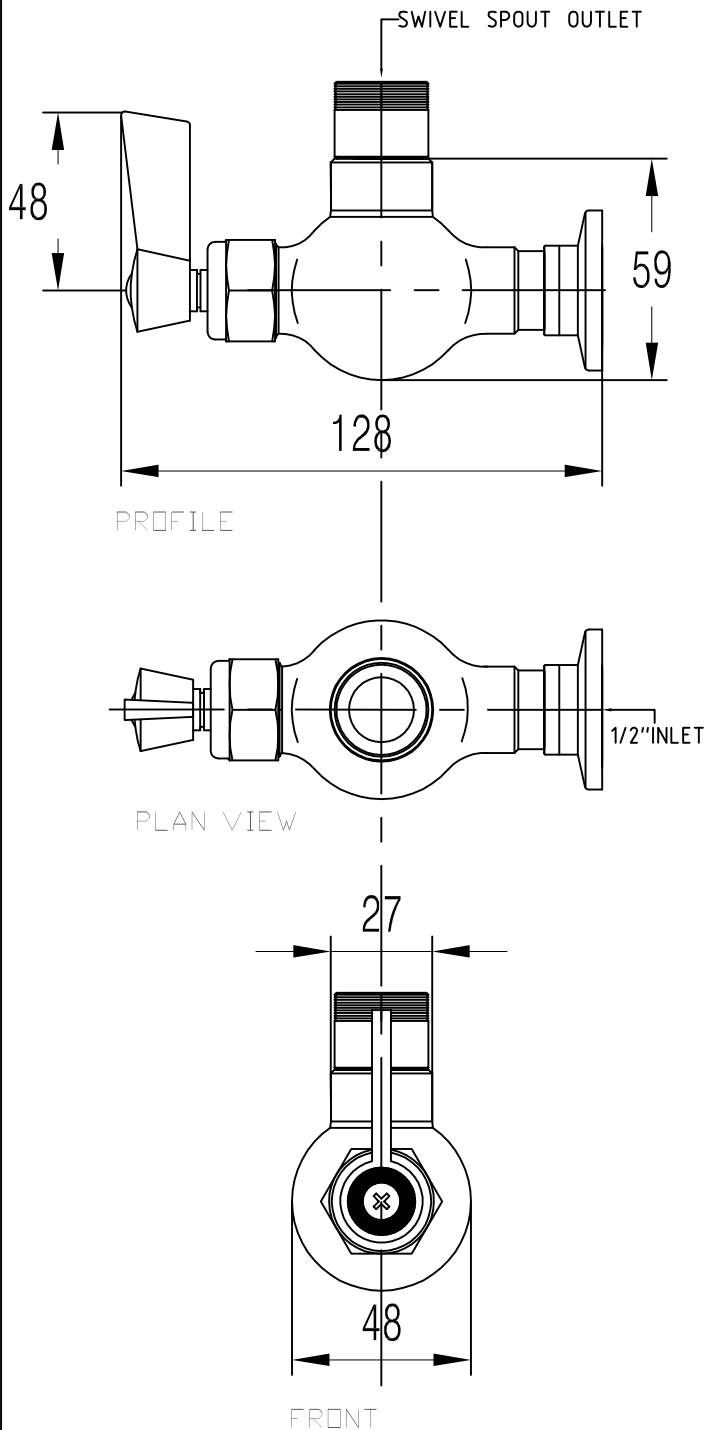

WATERMARK & WELS:

Global Tapware Pty Ltd is a Watermarked, level 1, Company.
All relevant products & components are WELS registered.

Special Notice:

- 1 - We reserve the right to make changes to products and drawings without notice.
- 2 - All drawings & Documents are subject to copyright ©.
- 3 - Seek written consent by us to reprint / use for other than specification work

GLOBAL STAINLESS SERIES PT.NO. GS11S
S/S SINGLE WALL TAP with SWIVEL OUTLET