



PRODUCT NAME:
GLOBAL STAINLESS SERIES
S/S SINGLE WALL TAP WITH SWIVEL SPOUT

PART NUMBER:
GS11S3006+others (see chart below)

DESCRIPTION:
S/S SINGLE TAP BODY WITH SWIVEL SPOUT
WITH 360 DEGREE SWIVEL CHECK STEMS
JUMPER VALVES.



TECHNICAL INFORMATION:
- IDEAL WORKING PRESSURE:- 65 PSI
- REC'D Min. OPERATING PRESSURE: -45 PSI
- MAXIMUM PRESSURE = 200 PSI STATIC (in short periods)
- WORKING TEMPERATURE :- 5 C - 65 C

SUPPLIED WITH:
- S/S TAP BODY
- S/S SWIVEL SPOUT
- S/S 360 DEGREE SWIVEL CHECK STEMS JUMPER VALVES
- CP WALL COVER FLANGE

FEATURES:
TAP BODY:
- S/S BODY
- S/S INTERNAL WORKINGS
- CP LEVER HANDLES
- 1/2" FEMALE INLET

WELS:
- 3 STAR, 9lpm

REF	MODEL	LENGTH IN MM	TAP WITH S/S SPOUT
A	6" MODEL	179mm	GS11S3006
B	8" MODEL	227mm	GS11S3008
C	10" MODEL	276mm	GS11S3010
D	12" MODEL	326mm	GS11S3012
E	14" MODEL	376mm	GS11S3014

WATERMARK & WELS:

Global Tapware Pty Ltd is a Watermarked, level 1, Company.
All relevant products & components are WELS registered.

Special Notice:

- 1 - We reserve the right to make changes to products and drawings without notice.
- 2 - All drawings & Documents are subject to copyright ©.
- 3 - Seek written consent by us to reprint / use for other than specification work

GLOBAL STAINLESS SERIES
PT.NO. GS11S3006 + OTHERS
S/S SINGLE WALL TAP with S/S SWIVEL SPOUT

A/B/C/D/E

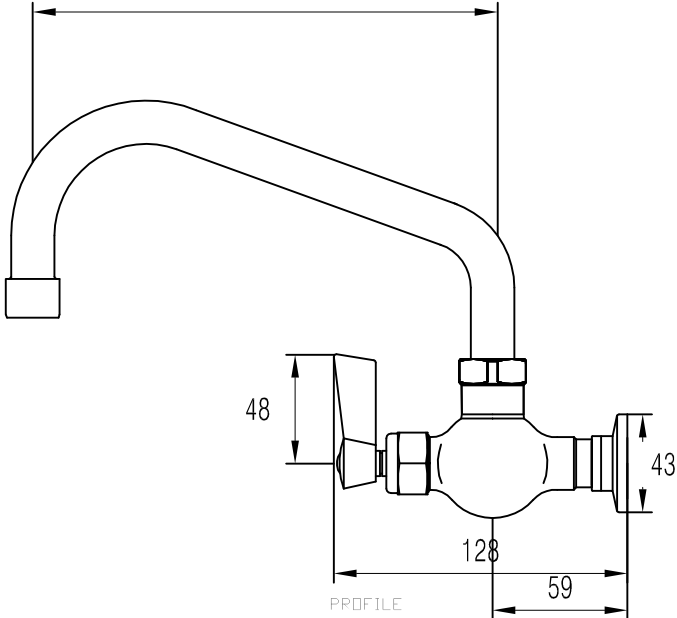

PROFILE

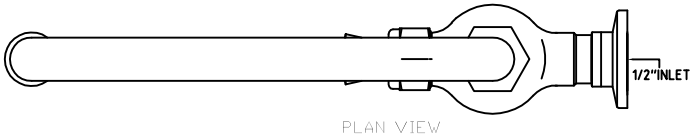

PLAN VIEW

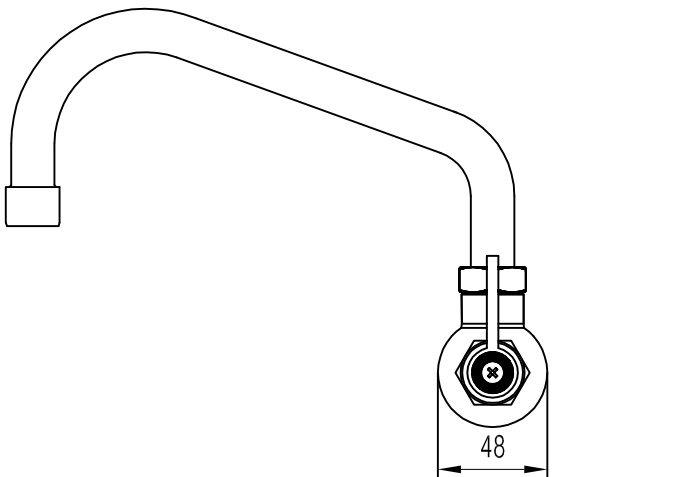

FRONT VIEW - bowl of tap