

# 'Global Fisher™' Standard Pre-Rinses

'TALL' -900mm (Unhooked) – 950mm (Hooked)

**Available Now**

**The KNUCKLE.** Allows Adjustable Wall Bracket Mounting System. Sold separately.

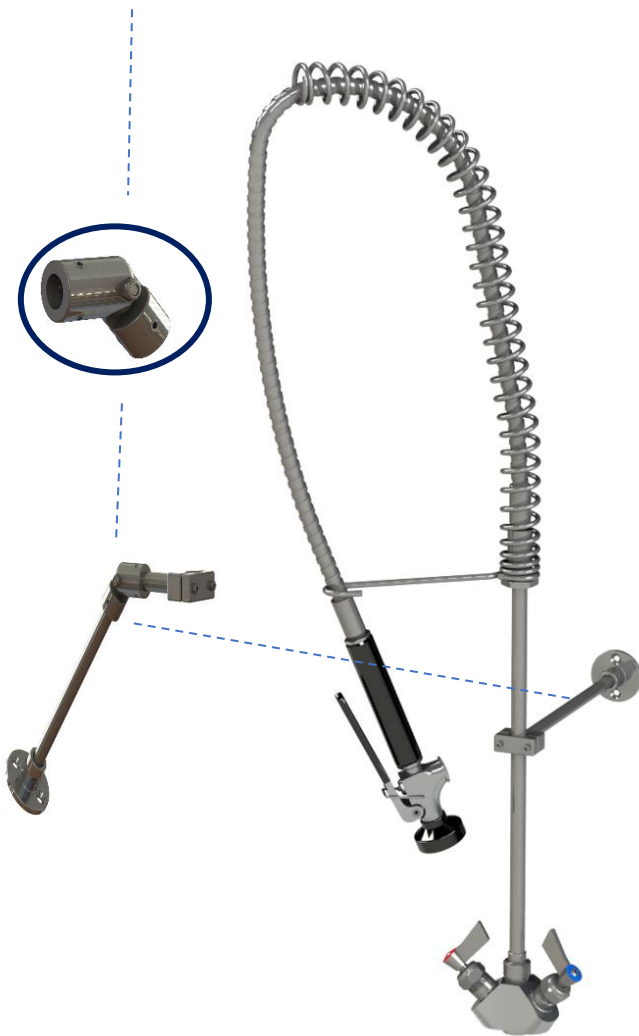

Product Code :- **GF032100**

RRP \$ \_\_\_\_\_ + GST



**\* More Products under the GF032100 Code :-**

- GF032100-M (Midi model - short 750)
- GF032100-C (Café model - short 650)
- GF032100-A (Adjustable Height 100mm)
- GF032100-SS (Made for RO Applications)
- GF032100-SM (Extra Side Tap to connect Hose)
- GF032100-SH (Hanging Hose/ Gun to Swivel)

## Features:

- All Component made from quality polished 304 S/S.
- Squeeze Lever has Lock-On & Quick release shut off - (OH&S Feature)
- Hot & Cold Lever Handles.
- "Drop N Lock" easy Installation System .
- Pre-assembled & tested Sub-Assembly in our Brisbane factory.
- Triple Interchangeable Spray Tips- Flat Fan, Shower, Pulse.

## WARRANTY:

- 36 Months for Commercial use

## Technical:-

Australian Standards : **Watermarked Lic. 23008**

**WELS Reg. No. T14467**

**1sts Outlet Spray Gun :**

WELS Rated : **6 Stars**

Flow Rate : **3.5 lpm**

Mounting Hole : **32 -35mm**

Material : **304 S/S**

Finish 1 : **Polished S/S**

Working Press. : **500kpa. (NPC)**

Max. Press. rate : **1500kpa.**

Operating Temp : **1 - 80° C.**

Global Tapware Pty Ltd

E – [sales.info@globaltapware.com](mailto:sales.info@globaltapware.com)

P – 07 38 55 2350

P – 1300 85 25 15

W- [GLOBALTAPWARE.COM.AU](http://GLOBALTAPWARE.COM.AU)

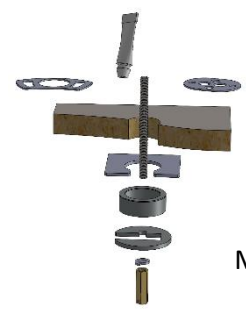
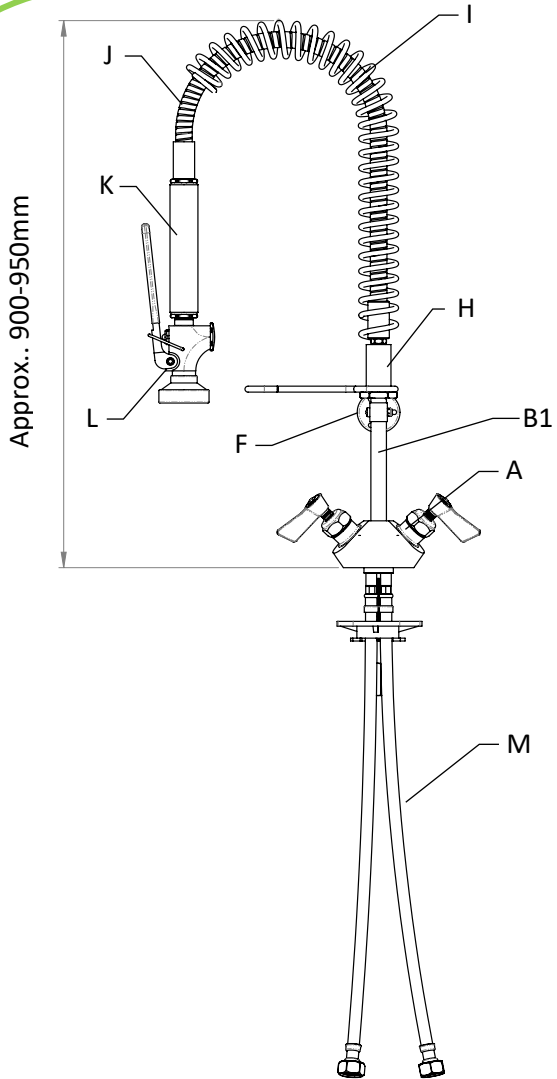

Mounting Kit

A	S/S Dual Hob Tap c/w Inlet Hose & Mounting kit
B1	S/S 16" RISER
F	S/S WALL BRACKET
G/H	S/S RETAINER + S/S w- CP HOOK
I	S/S w- CP SPRING GUARD
J	S/S ARMOURFLEX HOSE 920 mm LONG
K/L	S/S SPRAY GUN & Handle (3.5lpm/WELS 6 Star)
M	Inlet Hose – S/S End Fitting, EPDM, Nylon Braid - colour coded -Red & Blue band

**SPRAY GUN INTERCHANGABLE SPRAY TIPS**

**Spray Tip  
Supplied Fitted**

**Other Spray Tips  
Supplied**

FLAT FAN

SHOWER

PULSE

